

ACOUSTIC^S

PREMIUM

Masterful. Accentuated.



The natural ecological texture and low weight per unit area make it ideal for new construction as well as renovation. But it would not do the Admonter name justice if design were to take a back seat in these sophisticated acoustic elements. The Admonter Acoustic elements open up new possibilities for acoustic and visual interior design. The eye sees only a part thereof; the rest is seen with the ears!
Proven 100% sound absorption!



Type of wood	Thickn.	Dimension
Spruce	33 mm	200 x 2390mm
Larch	33 mm	200 x 2390mm
Stone Pine	33 mm	200 x 1800, 2100, 2390 mm
Oak	33 mm	200 x 2390mm
Oak finger jointed	33 mm	200 x 2390mm
Retro hacked H2	36 mm	200 x 1800, 2100, 2390 mm
Recl. Wood hacked H3	38 mm	200 x 1800, 2100 mm
Fir rift/semi rift finger jointed	35 mm	200 x 2390 mm

<https://www.admonter.eu/>

- CE marking according to EN 13964
 - Profile: all-round groove with MDF tongue for continuous installation
 - Reaction to fire according to EN 13501: D-s2, d0
 - Sound absorption class according to EN 11654: A
 - Sound absorption coefficient according to EN 11654: α_w 1,00
 - Acoustically open area: 17,5%
- PRODUCT CONSTRUCTION**
- Solid wood top sheet (cutting geometry: 15 mm web – 3 mm slot)
 - 30 mm honeycomb core
 - Dimension approx. 33 x 200 x 2390 mm
 - Acoustic fleece rear lining (simultaneous trickle protection)
 - installation guide please find on admonter.at/downloads

- Surface weight / element: approx. 4,4 kg/m²
 - Surface: untreated or natural oiled
 - Can also be used on radii and bends
 - Free of pollutants and respirable fibres
 - Vapour diffusive
 - Ambient area: room temperature 10 - 30°C / humidity 25 - 65% / (short-term exceeding or undershooting possible)
- PROCESSING**
- Efficient and simple machining with conventional woodworking machines
 - Concealed, tool-free installation by means of the Admonter ACOUSTICS fastening system or
 - Direct fastening with clips or clinched nails through the MDF tongue
 - See the installation instructions for details

LEGEND:

- maximum sound absorption
- Ball-proof impact resistance handball
- Fire classification: D-s2, d0

ACOUSTIC PREMIUM

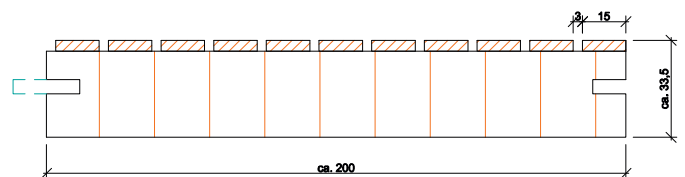

Ball-proof impact resistance certificated EN 13964, Annex D: Handball class 2A
The specifications as defined in the installation instructions must be followed.

SOUND ABSORPTION GRADE WITH BACKFILLING

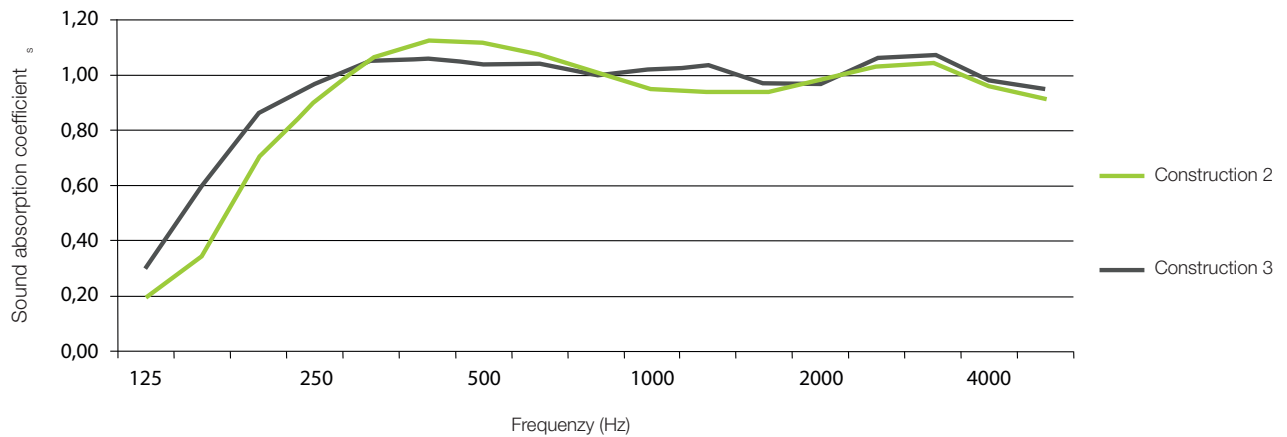

	Frequenz [Hz]	125	160	200	250	315	400	500	630	800	1000	1250	1600	2000	2500	3150	4000	5000
10 mm Air layer Structure 2*	a_s accord. EN 354	0,19	0,35	0,70	0,90	1,06	1,12	1,11	1,07	1,00	0,95	0,94	0,94	0,98	1,03	1,04	0,96	0,91
	a_p accord. EN 11654	0,20		0,90			1,00			0,95			1,00			0,95		
	SSA*				0,98													
	NRC*				1,00													
80 mm Air layer Structure 3*	a_s accord. EN 354	0,30	0,60	0,86	0,97	1,05	1,06	1,04	1,04	1,00	1,02	1,03	0,97	0,97	1,06	1,07	0,98	0,95
	a_p accord. EN 11654	0,35		0,95			1,00			1,00			1,00			1,00		
	SSA*				1,00													
	NRC*				1,00													

*NRC and SSA calculation based on ASTM C423

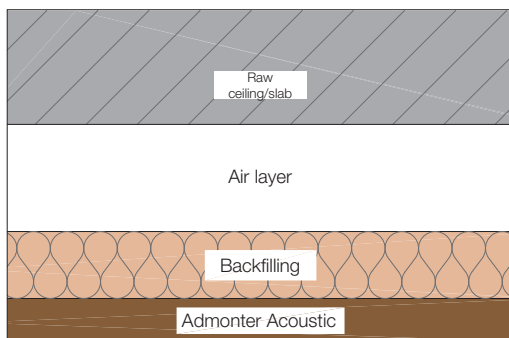

	Air layer	Backfilling	Total constr. height
Construction 2	10 mm	50 mm	approx. 93 mm
Construction 3	80 mm	50 mm	approx. 163 mm

ONLINE CALCULATION - TOOL

Use this service for your individual acoustic room design calculation:
<https://service.admonter.at/raumakustik/en.html>



SOUND ABSORPTION GRADE **WITHOUT** BACKFILLING

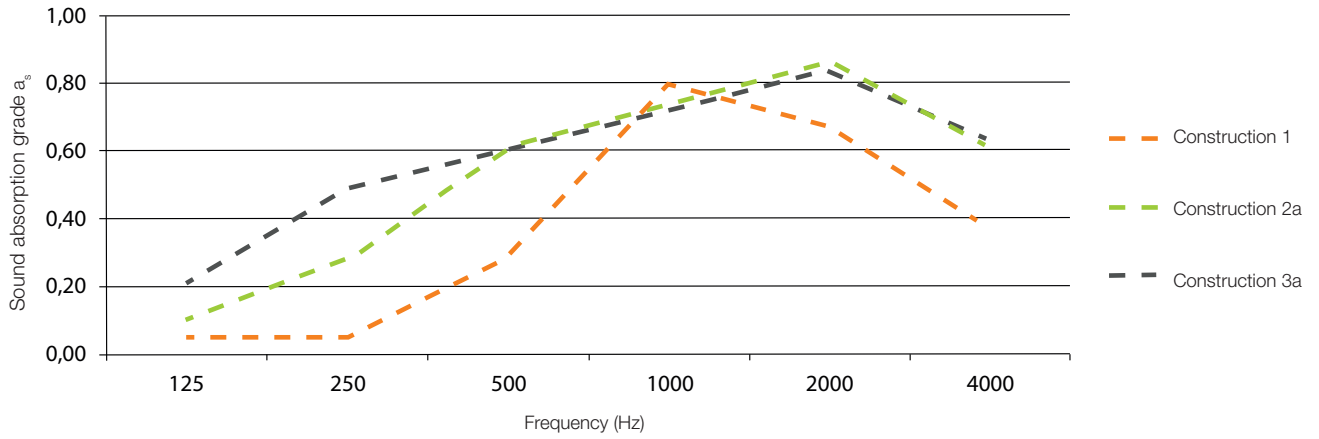

	Frequency [Hz]	125	250	500	1000	2000	4000
Construction 1	a_s according EN 354	0,05	0,05	0,29	0,80	0,67	0,37
Construction 2a	a_s according EN 354	0,10	0,28	0,61	0,74	0,86	0,61
Construction 3a	a_s according EN 354	0,21	0,49	0,61	0,72	0,84	0,63

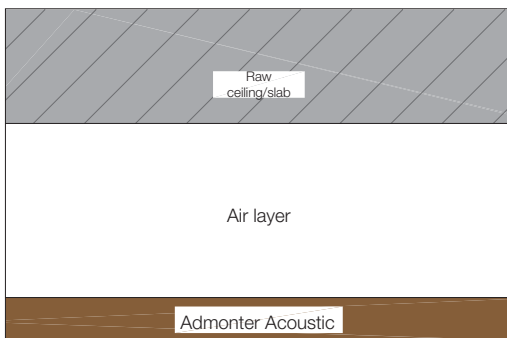

	Air layer		Total constr. height
Construction 1	15 mm		approx. 48 mm
Construction 2a	60 mm		approx. 93 mm
Construction 3a	120 mm		approx. 153 mm

ACOUSTICs INSPECTION OPENING

HIGH PERFORMANCE MAGNET for possible inspection opening ACOUSTICs

MAKE IT INVISIBLE.

The ACOUSTICs inspection opening with high-performance magnet provides the perfect solution to hide important elements (electrical box, water connection, etc.).

Please refer to the installation instructions for the inspection panel for basic handling, important information and installation at <https://www.admonter.eu/en/downloads/> (For small and medium opening versions.)

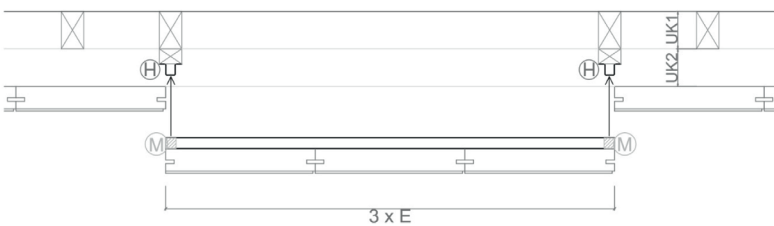
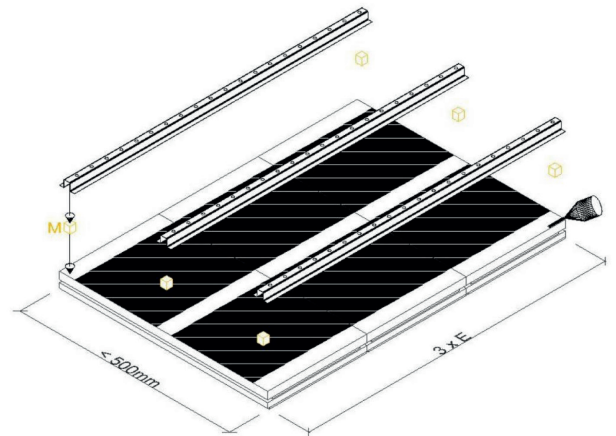
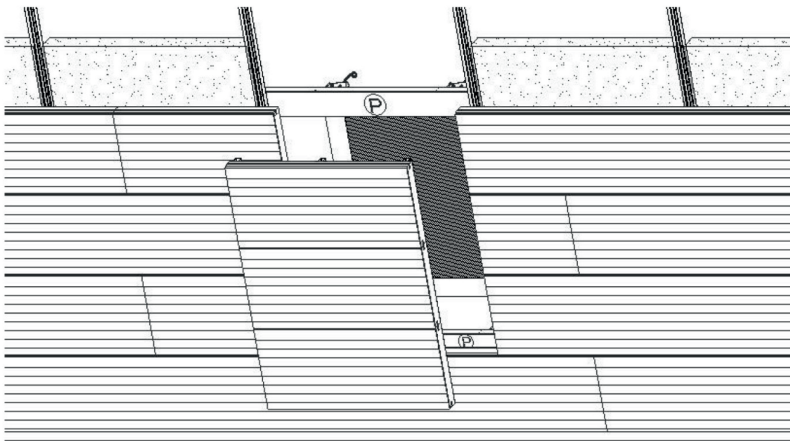

HIGH-PERFORMANCE MAGNET	
Dimension: 12 x 12 mm	
6 pcs. / package (for small and medium opening variants)	

NOTE:
The magnets must not be shipped by air freight.